

2

1

THIS COPY IS PROVIDED ON A RESTRICTED BASIS AND IS NOT TO BE USED IN ANY WAY DETRIMENTAL TO THE INTERESTS OF PANDUIT CORP.

NOTES, UNLESS OTHERWISE SPECIFIED:

PART MUST BE RoHS COMPLIANT.

- 1. DIMENSIONS IN BRACKETS ARE IN METRIC.
- 2. RECOMMENDED TOOL: CT-3001/ST
- 3. COMPATIBLE TOOLS: CT-2931/ST, CT-920CH, CT-930LPCH
- 4. WIRE SIZE: 400kcmil
- 5. CRIMPS: F94 FERRULES - ALL SIZES
- 6. DIE HALVES ARE HEAT TREATED TO Rc 32-35
- 7. DIE HALVES ARE NICKLON PLATED FOR LUBRICITY/DURABILITY

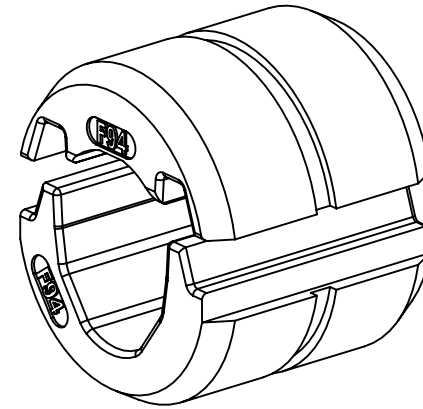
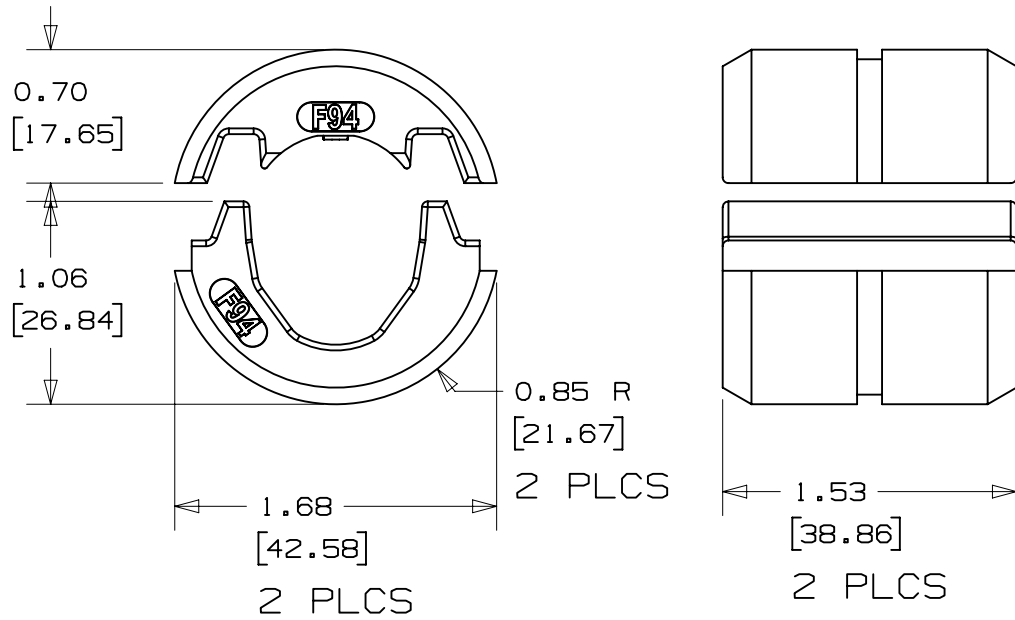

00	03-30-17	BJPU	JEH	JADE	RELEASED				012679

INSTALLATION INSTRUCTION NUMBER <b>PA28870A01</b>		FMEA & CONTROL PLAN NUMBER N/A	
TITLE <b>CD-920-F94 CUSTOMER DRAWING</b>			
CUSTOMER DRAWING			
ITEM REVISION NAME R28880AA/00		<b>PANDUIT</b>	
DATASET FILE NAME R28880AA-00-dwg1			
UNLESS OTHERWISE SPECIFIED, DIMENSIONAL TOLERANCES ARE: IN [mm]		MATERIAL: 4140 STEEL / RC 32-35	
.x ± .1 [ 2.54 ]      .xxx ± .005 [ .127 ] .xx ± .01 [ .25 ]      ANGLES ± 5 °		DRAWING NUMBER: <b>TD28880A01</b>	
THIRD ANGLE PROJECTION			
DRAWN BY BJPU	DATE 03/30/17	CHK JADE	SCALE 1:1
REV		SHT 1 OF 1	
DESCRIPTION		SIZE A	
ECN			

2

1