

REV	DATE	DESCRIPTION	ECO	BY	C'H'K.
G	12/23/2013 00:00:00 AM	DRAWING RELEASED	34443	AT	DD

D	BURNDY CATALOG NO.	FLAME RETARDANT CLEAR COVER CAT. NO	FLAME RETARDANT COVER CAT. NO	CONDUCTOR SIZES CODE(FLEX CABLE)				TOOLING(* NUMBER OF CRIMPS)				DIE INDEX AND EMBOSSEMENT	W ±.06	T ±.04	L ±.06			
				MAIN	TAP 1	TAP 2	TAP 3	Y35, Y39	*	Y750	*					Y46 9	*	COLOR CODE
	YCHC44TC44	CCFRFR	CFRFR	1000-750 (750-500)	1000-750 (750-500)						P1102	1	WHITE	1102	3.59 [91]	1.73 [44]	1.16 [29]	
	YCHC39TC39	CCFRFR	CFRFR	750-500 (550-500)	750-350 (550-350)						P1103	1	BLUE	1103	3.12 [79]	1.53 [39]	1.06 [27]	
	YCHC39TC31	CCFRFR	CFRFR	750-350 (550-500)	350-2 (250-2)	2-6 SOL (2-8)	8-14 (8-14)				P1103	1	BLUE	1103	2.96 [75]	1.53 [39]	1.31 [33]	
	YCHC39TC2	CCFRFR	CFRFR	750-500 (550-500)	2-6 SOL (2-8)	8-14 (8-14)					P1103	1	BLUE	1103	2.66 [68]	1.53 [39]	1.31 [33]	
	YCHC34TC34	CCFNFR	CFNFR	500-4/0 (350-4/0)	500-4/0 (350-4/0)					U1104	2	P1104	1	BROWN	1104	2.97 [75]	1.38 [35]	1.00 [25]
	YCHC34TC29	CCFNFR	CFNFR	500-4/0 (350-4/0)	250-2 (4/0-2)	2-6 SOL (2-8)				U1104	2	P1104	1	BROWN	1104	2.45 [62]	1.26 [32]	.94 [24]
C	YCHC34TC2	CCFNFR	CFNFR	500-4/0 (350-4/0)	2-6 SOL (2-8)	8-14 (8-14)				U1104	2	P1104	1	BROWN	1104	2.45 [62]	1.26 [32]	.94 [24]
	YCHC29TC29	CCDFR	CFDFR	250-2 (4/0-2)	250-2 (4/0-2)					U997	1	U997	1	ORANGE	997	2.12 [54]	.98 [25]	.94 [24]
	YCHC29TC2	CCDFR	CFDFR	250-2 (4/0-2)	2-6 SOL (2-8)	8-14 (8-14)				U251	1	U251	1	RED	251	1.78 [45]	.97 [25]	.81 [21]
	YCHC2TC2	CCFOFR	CFOFR	2-6 SOL (2-8)	2-6 SOL (2-8)	8-14 (8-14)		UC	1	UC	1	UC	1	BROWN	C	1.22 [31]	.60 [15]	.81 [21]
	YCHC8TC8	--	CF11FR	8-12 (8-12)	8-12 (8-12)			U240	1	U240	1	U240	1	RED	240	.53 [13]	.35 [9]	.56 [14]

NOTES:

- MATERIAL: COPPER.
- FINISH: TIN PLATE.
- FOR USE WITH COPPER OR TIN PLATED COPPER CONDUCTORS ONLY.
- ACCOMMODATES CODE CABLE, FLEX LOCOMOTIVE, AND FLEX CLASS I WITH SPECIFIED RANGES.
- RECOMMENDED CONDUCTOR STRIP LENGTH (CONNECTOR LENGTH + 1/8" MAX), CONNECTOR LENGTH SHOWN BY DIMENSION "L".

- 6 TAP 2 AND TAP 3 ARE OPTIONAL.
- 7 TO PROPERLY USE TAP 2 AND/OR TAP 3 CONDUCTORS IN THE YCHC CONNECTOR, A CONDUCTOR FROM THE TAP 1 CABLE RANGE MUST BE INCLUDED IN THE TAP 1 GROOVE.
- 8 PART MARKING TO BE ON CONNECTOR BACK SURFACE.
- 9 USE PUADPI ADAPTOR WITH U-DIES IN THE Y46.

10. DIMENSIONS IN BRACKETS [] ARE IN MILLIMETERS ROUNDED OFF TO THE NEAREST MILLIMETER, UNLESS OTHERWISE SPECIFIED, AND ARE FOR REFERENCE ONLY.

CORPORATE IDENTIFIER

8 (TYPICAL LETTERING)

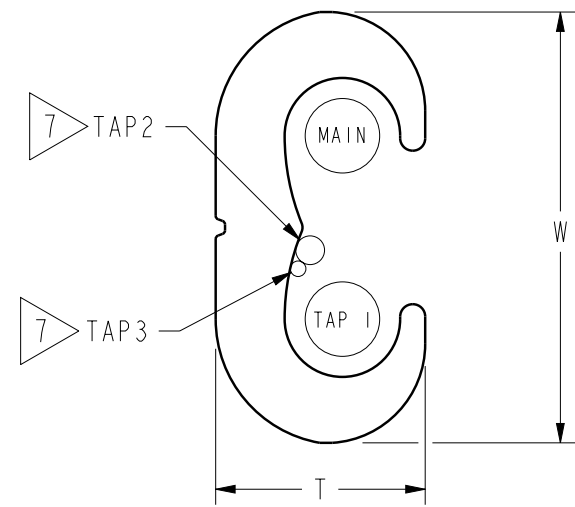
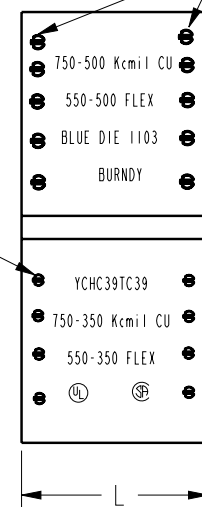

TO ORDER BURNDY® PRODUCTS CALL		ITEM NO: N/A	
UNITED STATES: 1-800-346-4175 (LONDONDERRY, NH)		CAT. NO: YCHC -----(TABLE)	
CANADA: 1-800-361-6975 (QUEBEC) 1-800-387-6487 (ALL OTHER PROVINCES)		DRAWN BY: R. BOISVERT 12/27/05	
FOR PRODUCT INFO: http://www.burndy.com		CHECKER: J. MICHAUD 12/02/09	
		DSN APPVL: J. MICHARD 12/02/09	
		MFG APPVL: J. HEAD 12/02/09	
		QA APPVL: T. WATTS 12/01/09	
		MKT APPVL: J. SYLVIA 12/01/09	
		SCALE: 3:1	
		PROD FAM: CM&R_COMPRESSION	
		DRAWING NO	
		REV	
		PROJECT #: --	
		SIZE	
		DOCUMENT TYPE: Sales	
		SD206624-01	
		SHEET 1 OF 1	
		REL LEVEL: Released	